





18 Thorpe Road
London, N15 6NR
£1,146

 1  1  nul 

18 Thorpe Road, London, N15 6NR

Spacious studio in the quiet residential area of Stamford Hill, with en suite private bathroom to rent, withn the building there is a large modern, communal kitchen and a scenic rear garden.

Recently decorated, and situated in a charming house, the Stamford Hill area boasts plenty of green spaces, independent shops, florists, hair salons, bakeries, supermarkets and high street gyms, the studio is situated within a 2-minute walk from the local overground station. Bus routes also provide easy access to Clapton and Hackney, and the vibrant Church Street in Stoke Newington, there are buses that go to Seven Sister's tube station in South Tottenham as well as Finsbury park.

Key features:

Communal kitchen and scenic, well-kept garden

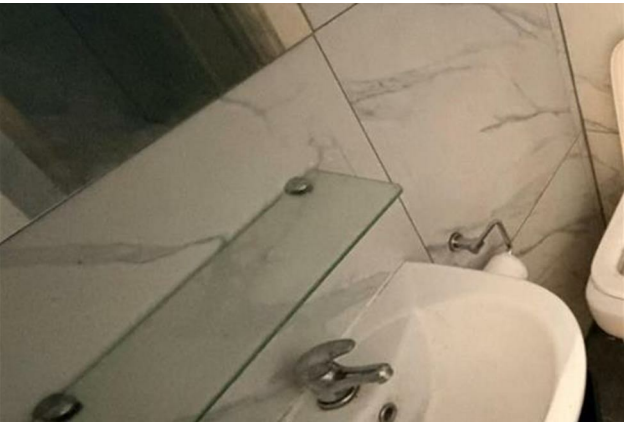

Area Map



Floor Plan

Energy Efficiency Graph

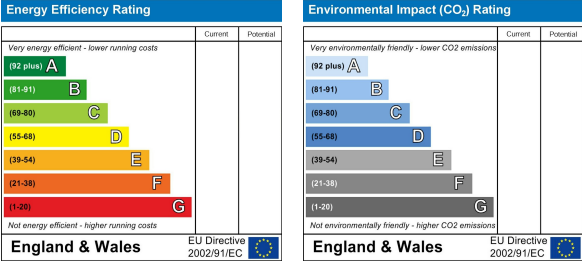

These particulars, whilst believed to be accurate are set out as a general outline only for guidance and do not constitute any part of an offer or contract. Intending purchasers should not rely on them as statements of representation of fact, but must satisfy themselves by inspection or otherwise as to their accuracy. No person in this firms employment has the authority to make or give any representation or warranty in respect of the property.